

www.jointhefun.us

100+
Google
★★★★★
FIVE STAR REVIEWS
Over 100
5-Star Google Reviews

Stefan's
Join the Fun Tours
321-594-0392
www.jointhefun.us



TRAVEL GROUPS
FOR SENIORS

AIR INCLUDED, TRANSFER
FROM HOME



Group Tour Presented by
Stefan's "JOIN THE FUN TOURS"
TULIP TIME ON THE RHINE AND GOLDEN PASS
RAIL JOURNEY the Netherlands
Germany • France • Switzerland
April 9-23, 2027 *2 Night Pre-Cruise Hotel in Amsterdam Included

Celebrate springtime splendor on an unforgettable journey combining a Rhine River cruise with Switzerland's iconic Golden Pass Rail. Marvel at Keukenhof's brilliant tulips, cruise past storybook castles and vineyards along the Rhine, and explore charming villages and vibrant cities. Savor alpine beauty, medieval castles, and panoramic train views, creating unforgettable memories from this remarkable river, and rail adventure.

*Join the Fun Group Package Includes 2-night Hotel pre-cruise in Amsterdam offers enough time to explore highlights like canals, museums (Rijksmuseum, Van Gogh Museum, Anne Frank House), Jordaan district, and experience evening canal cruises.

EXCEPTIONAL INCLUSIONS

- 25 Meals: 11 breakfasts, 6 lunches, and 8 dinners
- Airport transfers on tour dates when air is provided by Mayflower Cruises & Tours
- Visit four countries
- Seven-nights in a suite or stateroom of your choice onboard the vessel
- First-class service by an English-speaking crew
- All gratuities included
- Explore the magnificent Keukenhof Gardens
- Shore excursions with English-speaking local guides
- Visit UNESCO World Heritage Sites
- Personal listening device for shore excursions
- All meals included onboard
- Variety of international cuisine
- Complimentary regional wines, beer, and soft drinks with onboard lunches and dinners
- Onboard Activity Manager will support all Emerald ACTIVE excursions and host daily onboard wellness activities, games, classes, and evening entertainment
- Complimentary bottled water in your stateroom
- Complimentary WiFi onboard
- Complimentary bicycles onboard for use ashore
- All port charges included
- Four-night hotel stay and touring in Lausanne
- Visit to Château de Chillon on Lake Geneva
- Cruise on Lake Geneva
- Scenic journey aboard the Golden Pass Railway
- Glacier 3000 Mountain Adventure



DAY 1 Overnight Car Parking from Ormond & Viera with Transportation to Orlando International Airport. AIR INCLUDED Economy Class (Comfort Plus, Business & First-Class Flight Options Available *Upgraded Cost) Depart the USA Depart the USA on your overnight flight to Amsterdam, the Netherlands.

DAY 2 Arrive Amsterdam with (2) Hotel Pre-Nights Included with your "Join the Fun" Group Package. Hotel TBA--Explore the City on your own, Join the Fun will offer Options to Experience prior to departure.

DAY 3 Amsterdam on your own with many sights to see, explore and eat on your own.

DAY 4 Amsterdam, the Netherlands Welcome to Amsterdam, a fascinating 700-year-old city of picturesque canals, world class museums, and cafés. You will be met and transferred from the airport to your Emerald Cruises Star-Ship. Become acquainted with the amenities of your ship or begin exploring the city. This evening, join your fellow travelers for dinner onboard. Meal: D

DAY 5 Amsterdam This morning, depart by coach for an included visit to Keukenhof Gardens. Discover why it's called the 'Garden of Europe' as you admire gorgeous flowers at the peak of tulip season. Colorful displays of tulips, hyacinths, orchids and other flowers stretch as far as the eye can see as you stroll along the perfectly manicured meandering paths. Return to the ship for your first day cruising through the Dutch countryside, passing windmills, and sailing through locks towards the Rhine River. Tonight, enjoy a welcome reception and gala dinner. Meals: B, L, D

DAY 6 Düsseldorf – Cologne This morning, join a walking tour of Düsseldorf, a vibrant city renowned for its stylish boutiques and charming Old Town. Stroll along the picturesque Rhine River, admire the stunning architecture, and discover hidden gems off the beaten path. Later this day we will arrive in Cologne, famous for its Gothic Cathedral. This afternoon you can immerse yourself in the city's lively atmosphere, indulge in delicious local cuisine, and experience the unique charm of the city. Meals: B, L, D

DAY 7 Koblenz Begin the day sailing through the spectacular UNESCO World Heritage Rhine Gorge. Pass countless medieval castles and vineyards lining the shores of this section of the river, with photo opportunities around every bend. See the infamous Lorelei statue and Pfalzgrafenstein Castle, built on an island in the middle of the river as a medieval toll station. Continue cruising to the 2000-year-old town of Koblenz, situated at the confluence of the Rhine and Moselle Rivers. Enjoy a walking tour of Koblenz seeing the German Corner where the 2 rivers meet and the Church of Our Lady. Meals: B, L, D

DAY 8 Mannheim – Schwetzingen Relax onboard as the vessel cruises along the Rhine River to Ludwigshafen. Upon arrival travel by coach to visit Schwetzingen Palace, famous for the beauty and harmony of its gardens. Visit the interior of the palace, along with the beautiful gardens, maintained in their original design. Today they remain a cultural heritage site of European significance and contain more than 100 sculptures scattered throughout the grounds. Alternatively, embark on an active journey to the quaint wellness town of Bad-Dürkheim for a hike through the beautiful vineyards. Meals: B, L, D

DAY 9 Kehl / Strasbourg, France Once docked in Kehl, travel by coach across the river to Strasbourg, the capital of the Alsace region in France. Your guided walking tour includes the Grande Île - the historical city center and UNESCO World Heritage Site. Known for its medieval black and white timber framed buildings, old tanning houses, baroque sandstone buildings, canals and river locks, the city's star attraction is the cathedral, dominating the main square. This evening, local entertainment is performed onboard. Meals: B, L, D

DAY 10 Breisach, Germany / Freiburg On today's adventure, visit the city of Freiburg, considered the 'capital of the Black Forest'. Aside from seeing the lovely sights, sample true Black Forest delicacies from the lively market in the city center near the main cathedral. Alternatively, join a guided bike tour in Breisach. Meals: B, L, D

DAY 11 Huningue – Lausanne, Switzerland After breakfast, disembark the ship in Huningue and be transferred by coach to the beautiful city of Lausanne. The remainder of the day is at leisure to begin exploring your new surroundings. Enjoy an included dinner this evening at the hotel. Meals: B, D

DAY 12 Lausanne Begin the day with a panoramic tour of the city, known around the world for its spectacular setting, and home of the International Olympic Committee and Museum. This afternoon, visit Château de Chillon, one of Europe's best-preserved medieval castles, on the shores of Lake Geneva. Surrounded by breathtaking scenery, discover the history of this 13th-century fortress. Learn about the château's association with famous authors and artists; the counts and dukes who inhabited it as well as the prisoners who occupied the jail; see period furnishings, art treasures, and frescoes. The beauty of the area continues to amaze during a cruise on Lake Geneva from the harbor in Montreux. Relax onboard as the spectacular scenery unfolds while sailing back to Lausanne before returning to the hotel. Meal: B

DAY 13 Lausanne / Golden Pass Today may be a highlight of your time in Switzerland as you experience a unique rail journey and mountain adventure. Depart by coach to Montreux where it's 'all aboard' the Golden Pass for an unforgettable panoramic train ride through the scenic landscapes of the Alps. Disembark the train in Gstaad where the coach is waiting to take you to Col du Pillon for the Glacier 3000 mountain adventure. Ascend via Ariel cable car to an altitude of approximately 9850' above sea level where you are met with astounding panoramic views, including the Matterhorn and Jungfrau. Walk across the world's first suspension bridge connecting two mountain summits, if you dare! Return to the hotel in Lausanne this afternoon. Meal: B

DAY 14 Lausanne the day is left free of planned activities for your independent exploration. If you prefer, join an optional excursion to visit the village of Gruyère (famous for cheese-making) and Maison Cailler Chocolate Factory. Meal: B

DAY 15 Lausanne / USA After breakfast, you will be transferred from Lausanne to Geneva airport for your flight home. Meal: B



JOIN THE PACKAGE INCLUDES: (16) Days Car Parking in Ormond and Viera with Transportation to Orlando International Airport r/t, Economy Air with 1 checked bag r/t, (2) Nights Hotel Amsterdam, Netherlands TBA, Transfer from Amsterdam Airport to Hotel and Hotel Geneva to Airport, (7) Night River Cruise on the Emerald Star- Ships (See Inclusions on River Cruise above), Gratuity to Florida Transfer Drivers, Ship Gratuity, Land Tour Gratuity, All Sightseeing, Train and Excursions seen above, (4) Night Post Cruise Mövenpick Lausanne, Taxes and Fees



TOUR ACTIVITY LEVEL



EMERALD STAR-SHIPS

Built: 2014-2026 Cabins: 91 Guests: 180 Length: 443 ft. Crew: 52

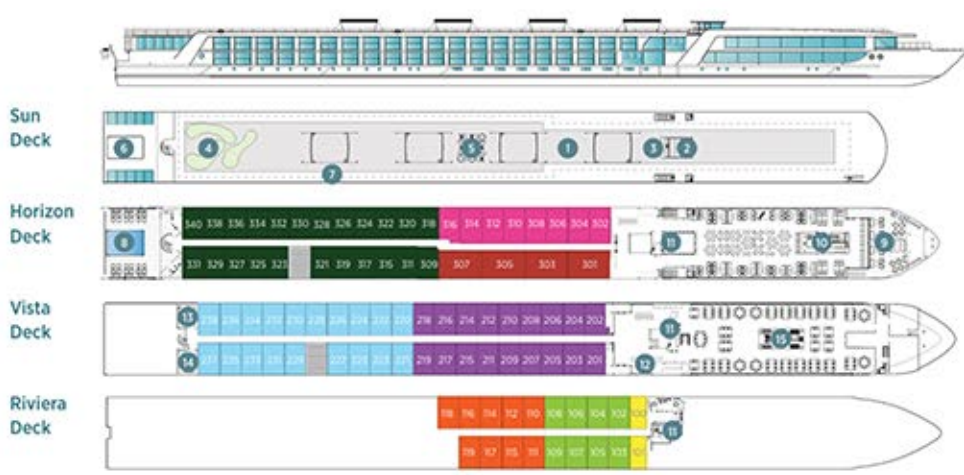

- 1 Sun Deck with Deck Chairs*
- 2 Navigation Bridge
- 3 Sky Barbecue
- 4 Golf Putting Green
- 5 Games Area
- 6 Retractable Glass Roof
- 7 Walking Track
- 8 Daytime Pool & Bar/Evening Cinema
- 9 The Terrace
- 10 Horizon Bar & Lounge
- 11 Lift
- 12 Reception
- 13 Wellness Area
- 14 Fitness Area
- 15 Reflections Restaurant

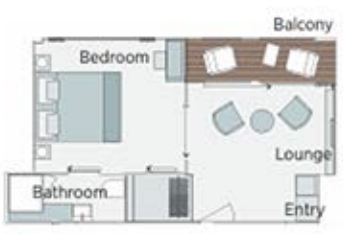

Owner's One-Bedroom Suite
285ft² - 315ft²

CAT SA



Grand Balcony Suite
207ft² - 210ft²

CAT S



Emerald Panorama Balcony Suite
160ft² - 189ft²

CAT A CAT B CAT C



Emerald Stateroom
153ft² - 170ft²

CAT D CAT E



Join the Fun Package
\$7,639PP Double SOLO Add \$5,054
***We offer Shared Roommate Match**

Yes, Join the Fun Tours offers Ladie's SOLO Match 321-594-0392
Call Join the Fun Tours to Book with a \$400PP Deposit
Partial Payment \$1,000PP June 1, 2026
Partial Payment \$1,000PP Oct 1, 2026
Final Payment Jan 1, 2027

Travel Insurance Recommended as Payment are non-refundable
Join the Fun Offers an Annual Travel Insurance Policy



DÜSSELDORF

Germany

